

Supermarine Spitfire LF XVIe



Quite arguably one of the best fighters of WW2 and best known for its actions in the Battle of Britain. The Spitfire was first flown in March of 1936, by the summer of 1940 the Spitfire had become Britain's primary day fighter. The aircraft was produced in great numbers with some 20,000 airframes being built in 47 different versions. It also was the only British fighter to remain in production throughout the war. With the superbly designed airframe and the Rolls Royce engine it's no wonder this plane became a legend in the skies.

Decals included in the kit are from RCAF 443 Squadron. They started operating the low flight (LF) XVIe version in late 1944. In June of 1945 they transitioned into the more powerful Griffon powered XIV. The LF XVIe was very similar to the MkIV version, the main differences being the airframe was designed around the Packard built Rolls Royce Merlin 266. The design also includes clipped wing tips for better low flight (LF) performance and a bubble top canopy for a full 360 vision.

Spitfire XVIe Specifications

Length	31' 3"
Wingspan	32' 7"
Power	Rolls-Royce (Packard) Merlin 266, 1,750 hp, V-12 engine
Performance	408mph
Armament	4 0.303" machine guns 2 20mm cannons

Spitfire LF Mk XVIe

Featuring marking of 443 Squadron



Wooden Semi Scale Model Kit

Easy build sandwich construction

No special tools required

PAINT NOT INCLUDED

1:66 Scale

FOR AGES 8 AND UP
SKILL LEVEL 2
Contains One Model Kit



KIT-6064

Building tips:

All parts will be a tight fit. If you find a part is too tight give it a bit of a sanding with 220 grit sandpaper. **DO NOT FORCE PARTS.** A hobby knife is suggested to cut the pieces from the part tree but most parts will break free easily. We recommend removing the burnt edge left by the laser with 220 grit sandpaper. This makes it easier for painting also it makes for a better appearance, especially if you are going to leave the model in its natural wood state. Although the model is designed to be assembled without glue, we do suggest gluing your model together. Note indicated parts that are not to be glued. Any black substance that gets on your hands is non toxic and can be removed with soap and water

 Indicates do not glue part or assembly

 Indicates part is a friction fit in order to hold in place

Recommended Tools:

Hobby Knife, Scissors, White Glue, 220 grit sandpaper

Step 3

Wings, propeller, cannons and exhaust

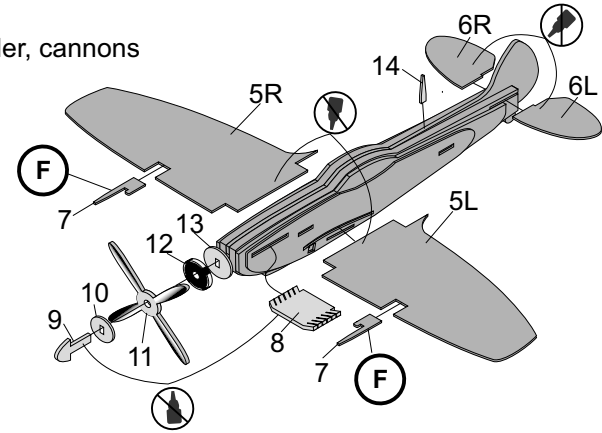

Step 1

Fuselage inner section and alignment blocks

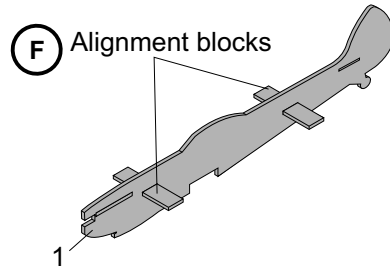

Step 4

Final assembly

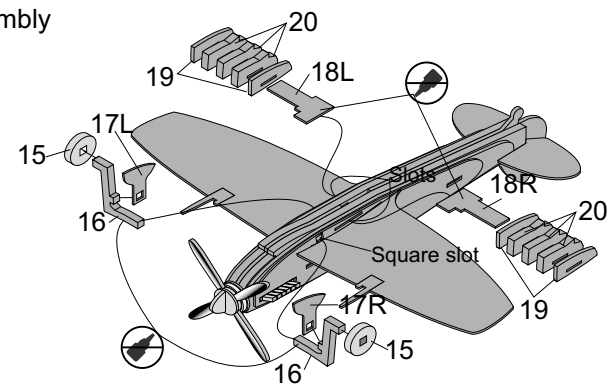

Step 2

Fuselage outer sections

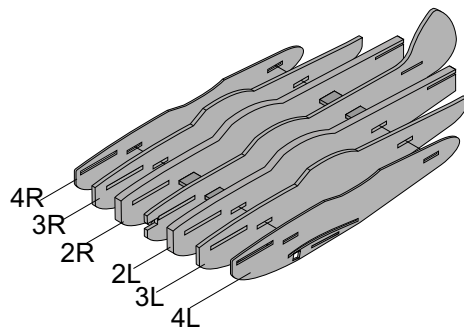

Step 5

Completed model ready for paint and decals. Please see separate sheet for paint and decal instructions.

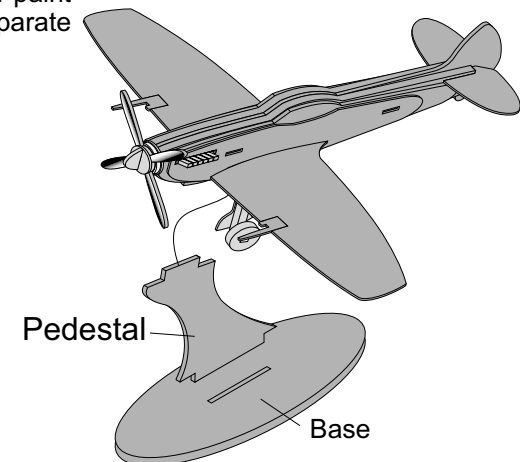



For small decals you may use a small utility knife to remove them from the backing and place in position.



Remove any vinyl that may be covering slots with a utility knife

Decals should be placed into position in numerical order. You will need to remove the wings, horizontal stabilizers, propeller assembly, exhaust, landing gear and radiator intakes to apply some of the decals.

Take your time.

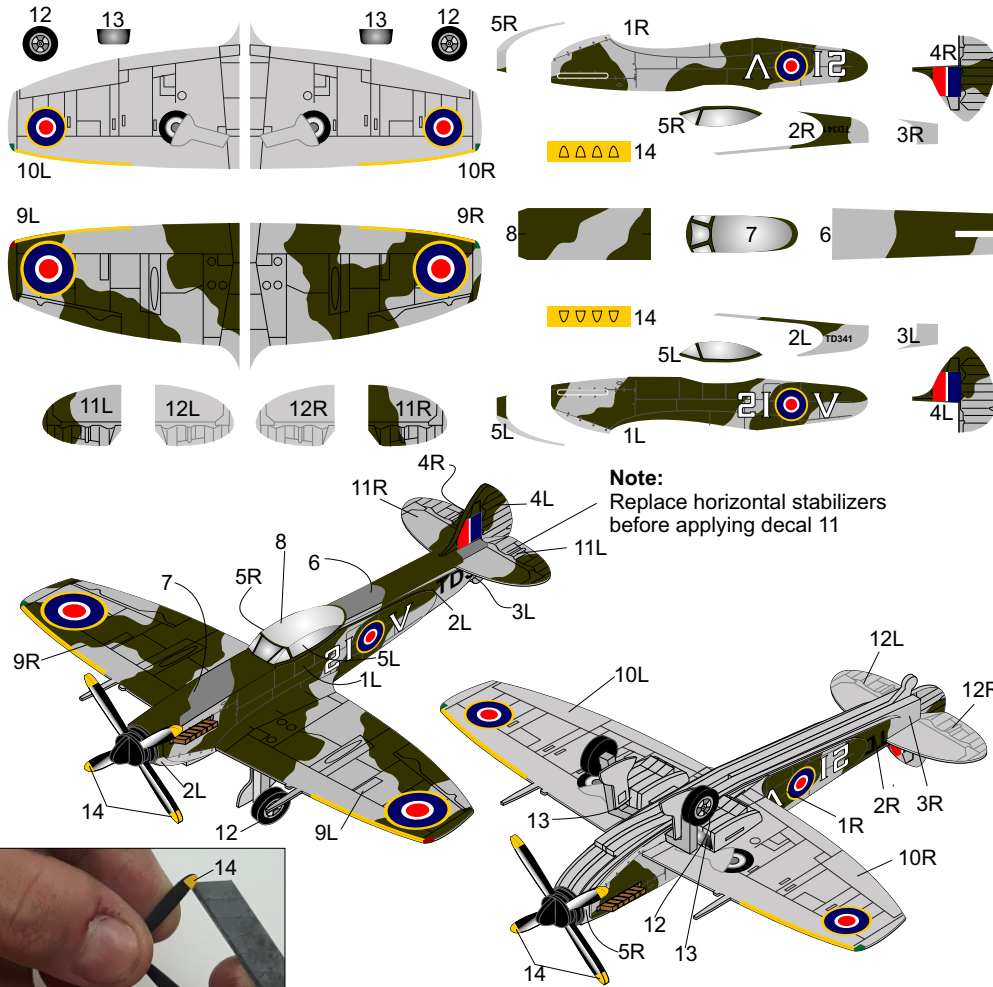

Note:
Replace horizontal stabilizers before applying decal 11

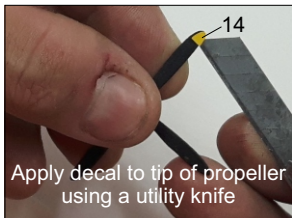

Apply decal to tip of propeller using a utility knife

Applying decals

Tools needed to apply decals

- Scissors
- Utility knife

Make sure your hands are clean before applying decals. Avoid contact with the adhesive as this can cause the decal to lose some of its adhesion. Decals will adhere better to a smooth clean surface so we do recommend painting your model for best results.

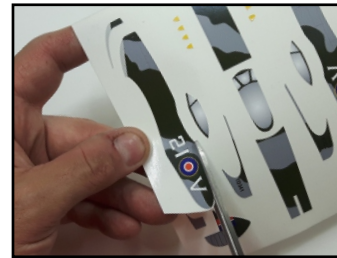

Cut out each decals as close to the edge as possible. Only cut out decals as needed.

Note:

Paint upper surfaces Sea Gray and under surfaces Light Gray before applying decals.



For the large decals, remove about a 1/4" of the backing and cut off with scissors.



Place the exposed section on the surface making sure that your decal is properly aligned on the part.



Peel and cut backing off in stages making sure the decal is staying aligned on the surface.

Colour Scheme of 443 Squadron Spitfire LF XVIe

Suggested colours by Tamiya Model Paints

- 1 **Dark Sea Gray XF54**
All upper surfaces
- 2 **Dark Green XF61**
Touch up for camouflage
- 3 **LT Gray XF66**
All underside surfaces
- 4 **Black XF1**
Propeller blades
Wheels
Nose cone of propeller
- 5 **Aluminum XF16**
Landing gear
- 6 **Yellow X8**
Tips of propeller
Leading edge

Note:

All upper surfaces should be painted Sea Gray
All under surfaces should be Light Gray

