

Cessna 172 Floatplane



The Cessna 172 Skyhawk is one of the most recognizable civil aircrafts in the world. There have been more 172's built than any other aircraft. The 172 was developed from the Cessna 170. The major difference being a change in landing gear configurations from tail dragger to a tricycle landing gear. The Skyhawk name was originally used for a trim package, but it was later applied to all standard production 172 aircraft. Skyhawks started to roll off the assembly line in 1956 and was an instant success, selling over 1400 units in the first year. Many different varieties were built throughout the years. Units were identified by their year and model by the use of a letter at the end of the 172's name. To make the aircraft more versatile the 172 could be configured to use amphibious floats. This allowed the aircraft to operate from land or water. Wheel fairings could be installed to reduce drag and increase fuel economy. After the 1962 model the rear fuselage was changed from the fastback look to the current wraparound or Omni-Vision allowing for a 360 degree view. Production ceased in 1986, however there was still demand for the aircraft and assembly re-started again in 1996 and continues today. As of 2008, more than 43,000 have been built.

The markings in this kit are not of any specific plane, but represent what a typical Cessna 172 Skyhawk would look like on floats around the 1968 K model year.

Cessna 172 Specifications

Length	27' 2"
Wingspan	36' 1"
Power	Lycoming IO-360-L2A four cylinder, horizontally opposed. 160HP
Performance	140mph max

Cessna 172 Floatplane



Wooden Semi Scale Model Kit

Easy build sandwich construction

No special tools required

PAINT NOT INCLUDED

1:66 Scale

FOR AGES 8 AND UP
SKILL LEVEL 1
Contains One Model Kit



6065

Building tips:

All parts will be a tight fit. If you find a part is too tight give it a bit of a sanding with 220 grit sandpaper. **DO NOT FORCE PARTS.** A hobby knife is suggested to cut the pieces from the part tree but most parts will break free easily. We recommend removing the burnt edge left by the laser with 220 grit sandpaper. This makes it easier for painting also it makes for a better appearance, especially if you are going to leave the model in its natural wood state. Although the model is designed to be assembled without glue, we do suggest gluing your model together. Note indicated parts that are not to be glued. Any black substance that gets on your hands is non toxic and can be removed with soap and water

 Indicates do not glue part or assembly

 Indicates part is a friction fit in order to hold in place

Recommended Tools:

Hobby Knife, Scissors, White Glue, 220 grit sandpaper

Step 3

Floats and struts

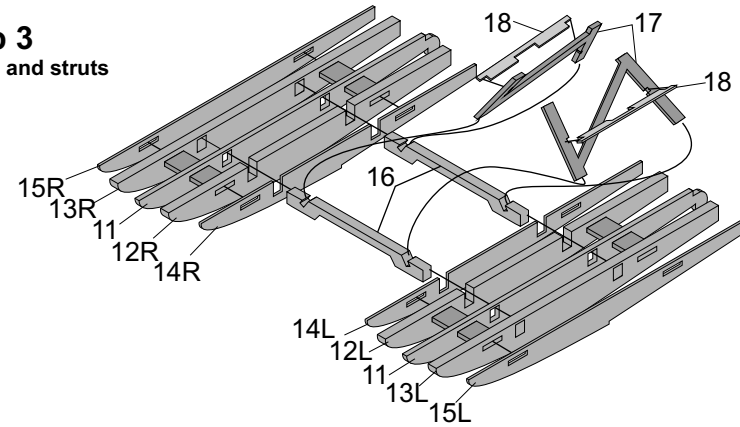

Step 1

Fuselage

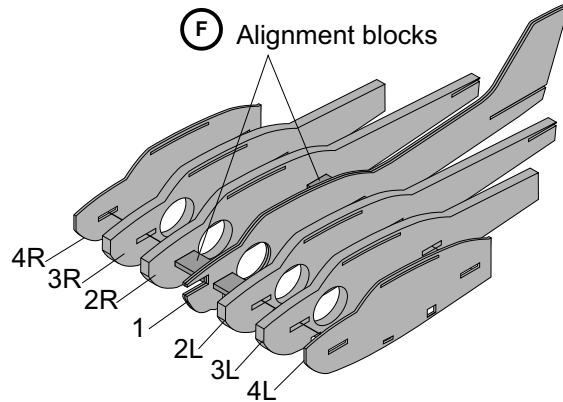

Step 4

Float installation

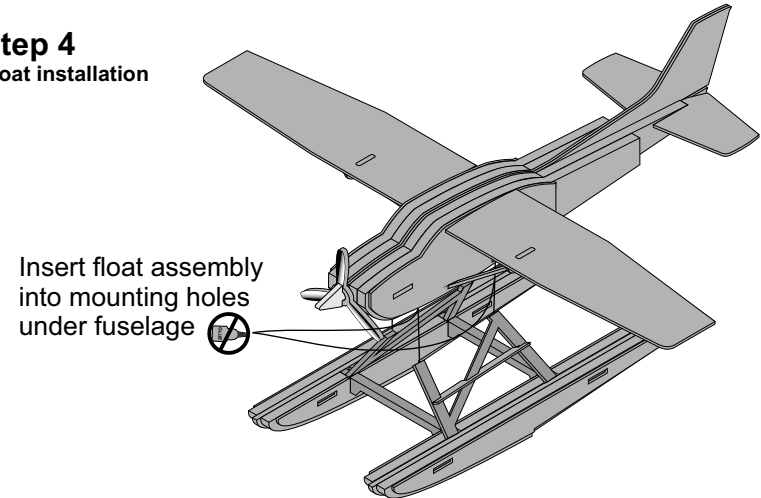

Step 2

Wings and propeller

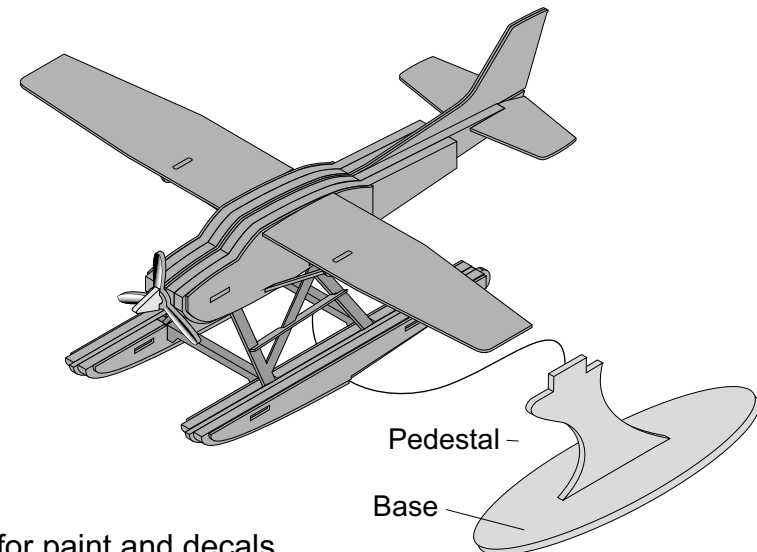
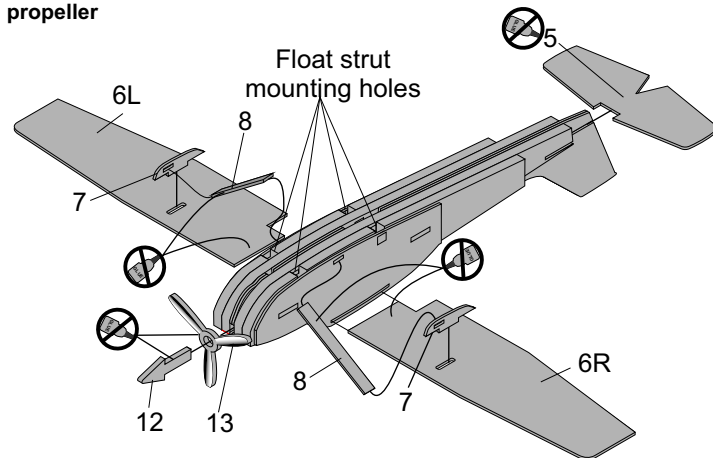

Ready for paint and decals

Decals should be placed into position in numerical order. You will need to remove the wings and struts, floats and Propeller to apply some of the decals.

Take your time.

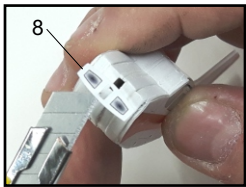
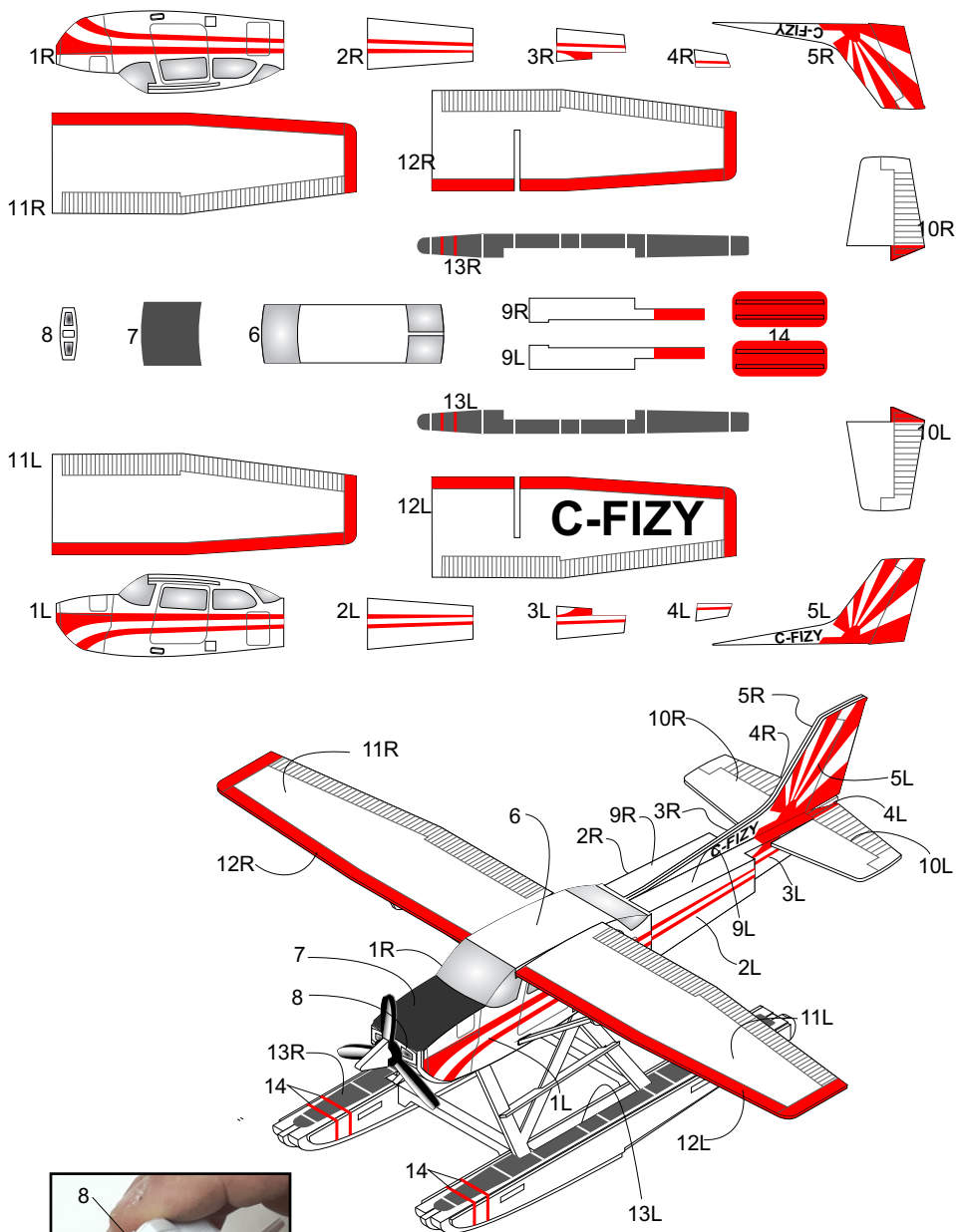

Applying decals

Tools needed to apply decals

Scissors, Utility knife

Make sure your hands are clean before applying decals. Avoid contact with the adhesive as this can cause the decal to loose some of its adhesion. Decals will adhere better to a smooth clean surface so we do recommend painting your model for best results.

Note: Paint entire aircraft white before applying decals.



Cut out each decal as close to the edge as possible. Only cut out decals as needed.

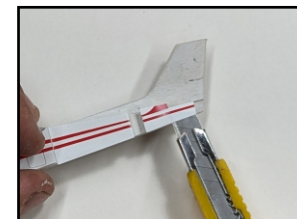

For small decals you may use a small utility knife to remove them from the backing and place in position.

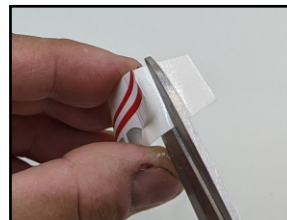

For the large decals, remove about a 1/4" of the backing and cut off with scissors.

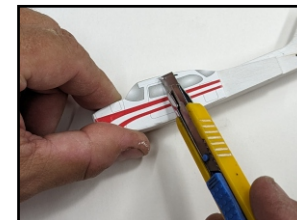

Remove any vinyl that may be covering slots with a utility knife



Place the exposed section on the surface making sure that your decal is properly aligned on the part.

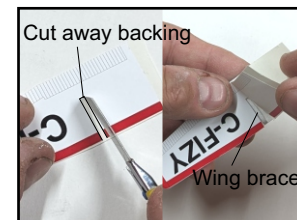

Cut away backing to allow the decal to fit around wing brace

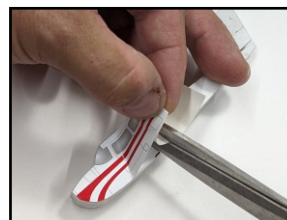

Peel and cut backing off in stages making sure the decal is staying aligned on the surface.

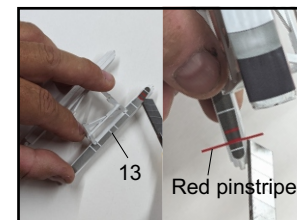

Place decal #13 onto top of float making sure it is centered. Center red pinstripe over top of red stripe and wrap around float.

Cessna 172 Skyhawk Seaplane

Suggested colours by Tamiya Model Paints

1 White X2

All upper and lower surfaces and floats

2 Red X7

Leading edges of wing, tail

3 Black XF1

Propeller



Note:

Model should be painted white before adding decals.

